



Use

A dedicated PC connection kit for all Optidrive models, allowing direct connection from the PC to the drive for use with Optitools Studio Software. The USB cable can be plugged into suitable USB type A on the PC and then into the RJ45 communications port on the drive.

Compatibility

This Option is compatible with the following products:

- CoolVert
- Compact
- P2
- Eco
- E3
- Elevator

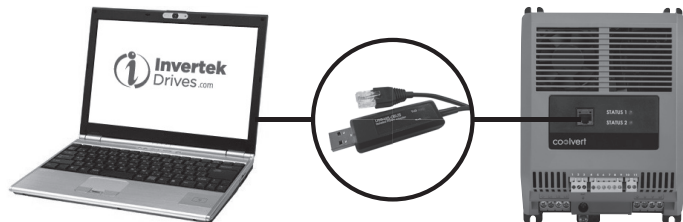

Model Code

OPT-2-USB485-OBUS

Technical Data

Temperature Range	0°C - 40°C
Protection Class	IP20
Weight	62
Isolation Class	III
Packaging	W 127cm x D 86cm x H 45cm

- Isolated USB – RJ45 connection adaptor.
- USB2.0.
- Compatible with windows XP, Vista, 7, 8, 8.1, 10 & 11.
- Supports Optitools Studio PC Software connection to the drive.
- 1.5 meter cable length.
- Driver's included in OptiTools for windows 10 & 11

Pin	Function
1	
2	
3	0V
4	RS485- (Optibus)
5	RS485+ (Optibus)
6	
7	
8	

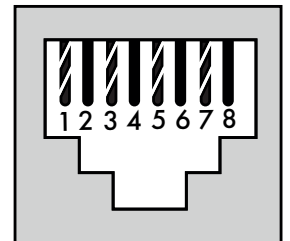

Safety

The RJ45 port on the drive is not an Ethernet Port.

WARNING This is not an Ethernet connection. Do not connect directly to an Ethernet port.

WARNING When using Modbus RTU or BACnet, ensure that the 0V signal (T3) is used to avoid comms errors and potentially damaging common mode voltages.

Inverterk Drives Ltd
Offa's Dyke Business Park
Welshpool
Powys, UK
SY21 8JF



82-USB485-IN_V1.01