



CLS-H – HIGH CAPACITY PANCAKE LOAD CELL 30tf - 1200 tf

Ⓞ FEATURES

- Fully environmental protection, IP67

Ⓞ Material

- Paint finished steel

Ⓞ Cable

- Braided shield 4-wire round cable with PVC-jacket



Ⓞ DIMENSIONS

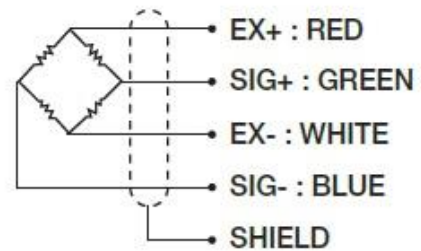
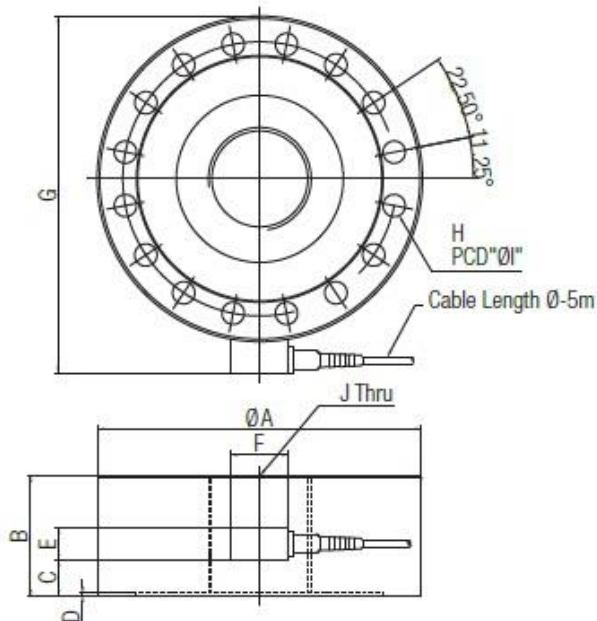

Model	Capacity	A	B	C	D	E	F	G	H	I	J
CLS-300	300 tf	378	140	42	3	38	68	417	16-Φ26	320	M120x4.0
CLS-500	500 tf	398	170	66	3	38	68	435	16-Φ26	335	M130x4.0
CLS-800	800 tf	488	200	81	3	38	68	525	16-Φ32	430	M150x4.0
CLS-1000	1000 tf										
CLS-1200	1200 tf	538	215	88.5	3	38	68	580	16-Φ39	445	M160x6.0

© SPECIFICATIONS

Max. Capacity		tf	300, 500, 800, 1000, 1200
Rated output		mV/V	2.0 ± 0.005
Zero balance		mV/V	0.0 ± 0.02
Accuracy class			
Combined error		%	1.0
Repeatability		%	0.5
Creep(30min.)		%	0.5
Temperature effect on			
Zero value		%/°C	0.1
Output value		%/°C	0.1
Excitation			
Recommended		V	10
Maximum		V	15
Resistance			
Input		Ω	400 ± 50 or 1400 ± 100
Output		Ω	350 ± 3.5 or 1400 ± 14
Insulation		MΩ	> 2,000
Compensated temp. range		°C	-10 ~ +40
Operating temp. range		°C	-20 ~ +80